

ACCESSIBILITY GUIDE

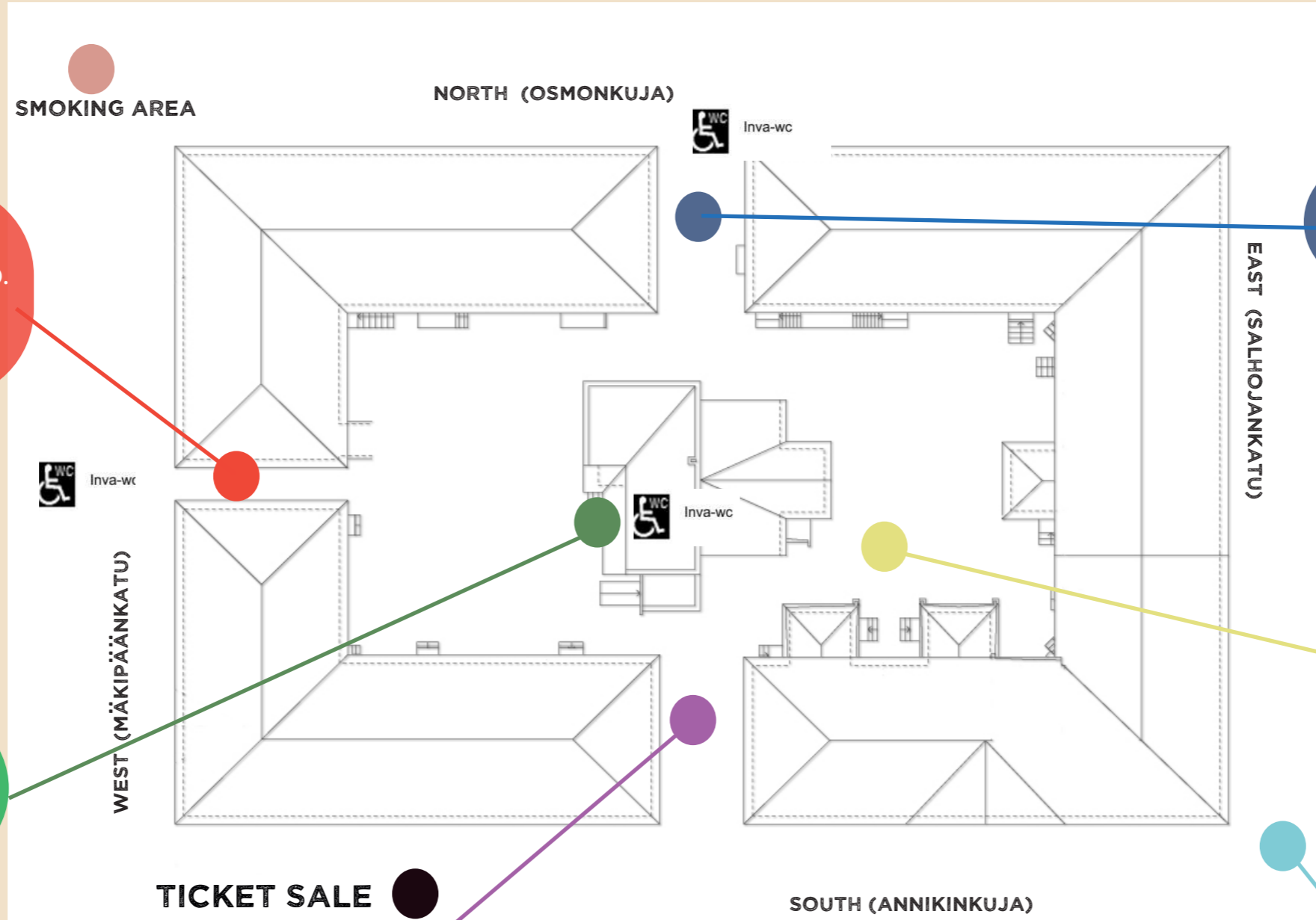

West entrance on the side of Mäkipäänkatu and Osmonpuisto. Annikki Food Court has one accessible toilet.



There are chemical toilets outside the North Gate. One of them is accessible.



The space for wheelchairs is in front of the stage on the right-hand side.



The Art Kiosk is not wheelchair accessible, but you can see the exhibition from the door.



The toilet space below the Sauna Stage, marked in green, has handrails and a wheelchair ramp.



There is a steep slope by the entrance and the ticket sale. If necessary, we can guide our customers with reduced mobility through the west side gate.

ANNIKKI WOODEN HOUSE QUARTER
Visit address Annikinkuja 2, 33500 Tampere



There are significant level differences in the festival area. Ask for help if you need it. We are happy to assist!